

# TEAR SHEET

## Garland 30" Dual Lit Ring Flush Mount

Item # TOB 4522AI

Designer: Thomas O'Brien

Height: 10.5"

Width: 30"

Canopy: 5.25" Round

Finishes: AI, G, PN

Lightsource: Dedicated LED

Wattage: 35w (4200lm)

Weight: 22 Pounds

Note: UL Only | Able to Convert to Hanging

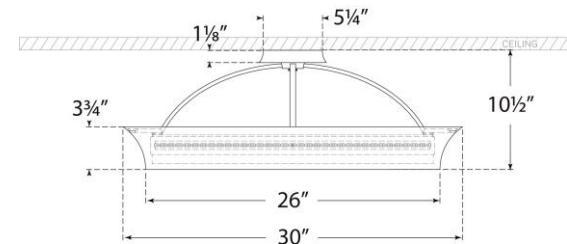

Front View

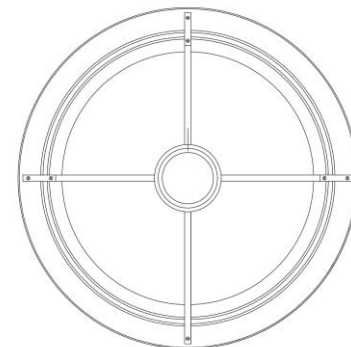

Top View